



**626-344-9779 / 833-448-6329**

**[www.HHBathandSafety.com](http://www.HHBathandSafety.com)**

**100% A.D.A Compliant**

**Made in the USA**

# **LIST PRICE SHEET**

# **NOVEMBER 2018**

## **TABLE OF CONTENTS**

Standard Series - Grab Bar Flange Designs	2
Standard Series - Bulk Line Stainless Steel Grab Bars	3
Standard Series - Satin Stainless - Grab Bars	4 - 6
Standard Series - Decorative Finishes - Grab Bars	7
Standard Series - Polished Brass - Powder Coated Grab Bars	8
Standard Series - Custom Grab Bars	8
Standard Series - Institutional Ligature Resistant Grab Bars	9
Standard Series - Copper Alloy Grab Bars with CuVerro® surfaces	9
Standard Series - Shower Rods, Flanges, Curtains & Rings	10 - 11
Standard Series - ADA Reversible Shower Transfer Seats	12
Standard Series - ADA Accessibility Shower Seats	13 - 16
Designer Series - Designer Shower Seat	17
Designer Series - Seats / Corner Shower Shelves	18
Designer Series - Grab Bars	19 - 20
Hospitality Series - Grab Bars	21
Hospitality Series - Bath Accessories	22-24
Bath Accessories - Stainless Series	25
Bath Accessories - Contemporary Series / Economy Series	26
Commercial Series - Commercial Washroom Accessories	27
Commercial Series - Commercial Accessory Line - Hospitality	28 - 29
Terms and Conditions	30

**H & H SERIES GRAB BARS****MADE IN THE USA**

ALL "EW" & "CR" FLANGE, STAINLESS BARS MEET FEDERAL SPECIFICATION WW-P-541/8b, AMENDMENT 1, 16 APRIL 1990; ANSI 117.1, AND ALL A.D.A. (Americans with Disabilities Act) CODE REQUIREMENTS.

THESE BARS, WHEN PROPERLY INSTALLED, MEET THE DOWNWARD PULL REQUIREMENT FOR FEDERAL SPECIFICATION WORK, F.H.A., V.A., HOSPITAL CODES AND PRIVATE CONSTRUCTION.

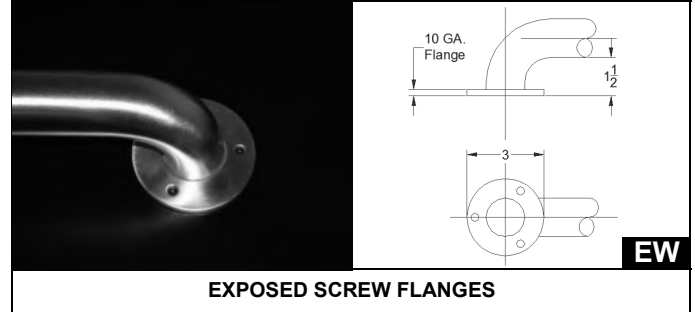
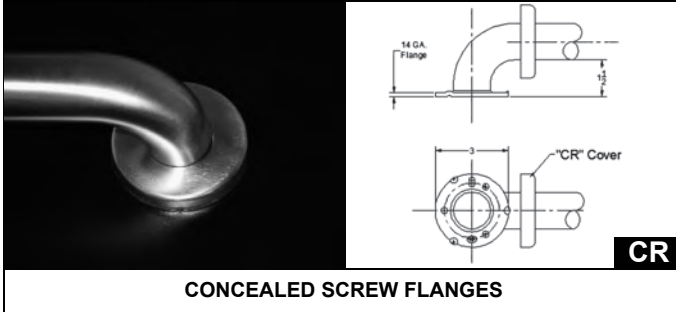
**FLANGE CONFIGURATIONS****MATERIAL & FINISH SERIES**

Satin #304 Stainless Steel  
 Polished #304 Stainless Steel  
 Peened with Satin Ends #304 Stainless Steel  
 Peened with Polished Ends #304 Stainless Steel "GB"  
 Polished #260 Solid Brass  
 Powder Coated #304 Stainless Steel

**BAR DIAMETERS**

"H" 1-1/2" diameter x .049" (18 gauge)  
 "Q" 1-1/4" diameter x .049" (18 gauge)

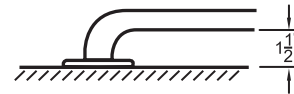
**STANDARD WALL CLEARANCE**

**H&H includes 6 - #10-2 1/2" Stainless Steel Phillips Head mounting screws packaged with each grab bar.**

**DECORATIVE CONCEALED FLANGE COVERS**

Add \$5.00 List per flange



ROPE "2"



RIDGE "3"



STEP "4"

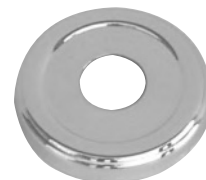

BAND "5"

H&H SPECIALIZES IN CUSTOM SIZES AND CONFIGURATIONS

\*\* CALL FOR TECHNICAL ASSISTANCE & COMPETITIVE PRICE QUOTES \*\*

**H&H BULK LINE - STAINLESS STEEL GRAB BARS****BULK LINE STAINLESS STEEL GRAB BARS**

Fabricated using #304 Stainless Steel with concealed flanges, our **BULK LINE SERIES** satisfies ADA Guidelines and Federal Specification WW-P-541/8b.

Our **BULK LINE SERIES** (10 per box) of Grab Bars will satisfy every ADA project and budget. By buying in quantities of 10, we are able to offer you a significant savings per bar, prices listed below.

**SATIN STAINLESS / "BSS" Series "Q"  
1-1/4" TUBE DIAMETER**

Size	List Per Bar
12"	22.80
16"	23.45
18"	25.70
24"	27.50
30"	29.70
32"	31.40
36"	32.85
42"	38.10
48"	41.90

**SATIN STAINLESS / "BSS" Series "H"  
1-1/2" TUBE DIAMETER**

Size	List Per Bar
12"	25.30
16"	26.50
18"	27.10
24"	30.85
30"	33.20
32"	35.40
36"	38.00
42"	40.70
48"	46.45

**POLISHED STAINLESS / "BXS" Series  
"Q" 1-1/4" TUBE DIAMETER**

Size	List Per Bar
12"	33.10
16"	37.30
18"	38.45
24"	40.05
30"	44.80
32"	45.65
36"	48.55
42"	52.35
48"	55.80

**POLISHED STAINLESS / "BXS" Series  
"H" 1-1/2" TUBE DIAMETER**

Size	List Per Bar
12"	35.10
16"	37.50
18"	38.75
24"	42.85
30"	48.10
32"	49.20
36"	52.40
42"	56.60
48"	60.70

**PEENED with SATIN ENDS / "BYS"  
Series "Q" 1-1/4" TUBE DIAMETER**

Size	List Per Bar
12"	29.30
16"	31.80
18"	33.20
24"	33.90
30"	41.60
32"	42.95
36"	45.75
42"	46.60
48"	49.90

**PEENED with SATIN ENDS / "BYS"  
Series "H" 1-1/2" TUBE DIAMETER**

Size	List Per Bar
12"	31.70
16"	33.90
18"	34.80
24"	39.65
30"	43.55
32"	45.15
36"	47.90
42"	50.25
48"	54.80

**PEENED with POLISHED ENDS /  
"ZS" Series "Q" 1-1/4" TUBE**

Size	List Per Bar
12"	36.05
16"	38.35
18"	39.45
24"	43.45
32"	49.50
36"	52.35
42"	60.10
48"	65.10

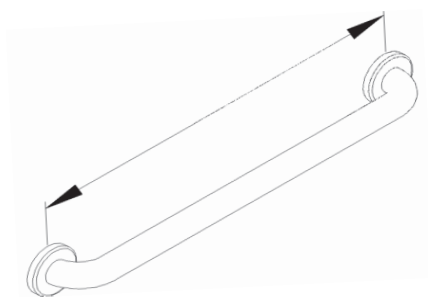
**H&H SERIES GRAB BARS - SATIN STAINLESS - STANDARD GRAB BARS****MADE IN THE USA****"S" STRAIGHT BARS**

Length	QEW	HEW	QCR	HCR
12"	40.30	44.00	41.00	44.90
16"	42.45	44.85	43.20	45.60
18"	44.00	46.65	44.90	47.40
24"	47.40	52.80	48.30	53.80
30"	51.55	55.65	52.75	56.75
32"	54.50	58.90	55.65	60.10
36"	56.45	62.10	57.50	63.35
42"	61.00	65.10	62.10	65.10
48"	63.70	70.10	64.85	71.40

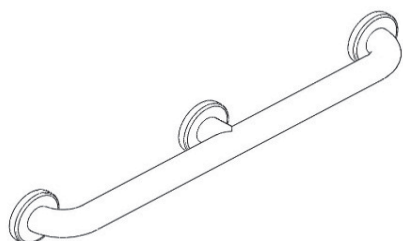
**"M" STRAIGHT BARS WITH CENTER POST**

Length	QEW	HEW	QCR	HCR
36"	79.10	86.40	79.10	86.40
42"	92.20	95.95	92.20	95.95
48"	95.80	103.95	95.80	103.95
52"	99.30	108.75	99.30	108.75
54"	101.90	110.60	101.90	110.60
60"	106.00	116.45	106.00	116.45

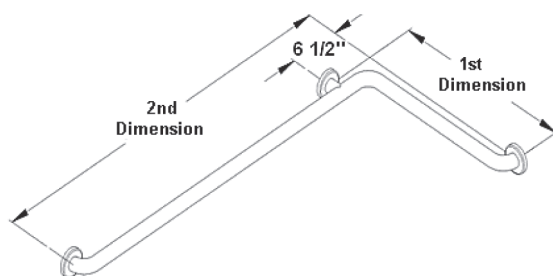
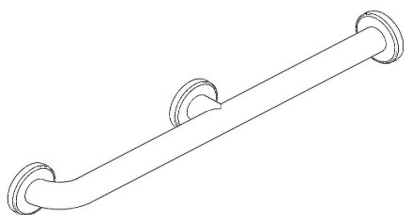
**"T" TUB & SHOWER BARS (REVERSIBLE)**

Length	QEW	HEW	QCR	HCR
16"x16"	115.85	136.70	115.85	136.70
16"x32"	122.40	140.85	122.40	140.85
24"x24"	122.40	140.85	122.40	140.85
20"x40"	134.85	159.75	134.85	159.75
24"x36"	134.85	159.75	134.85	159.75
24"x48"	149.15	172.60	149.15	172.60
30"x30"	134.85	159.75	134.85	159.75
36"x36"	149.15	172.60	149.15	172.60
36"x48"	162.80	183.85	162.80	183.85
36"x54"	169.45	189.60	169.45	189.60

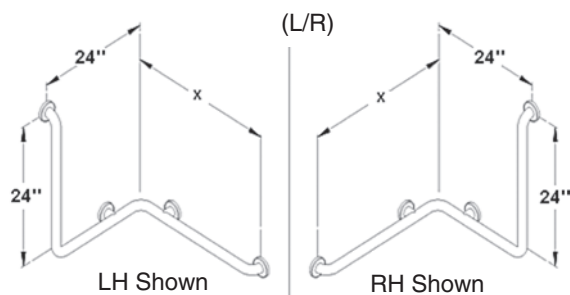
**"2 WAY" TUB / SHOWER BAR \*( LH or RH)**

Length	QEW	HEW	QCR	HCR
36"x24"x24"	307.45	322.40	307.45	322.40
48"x24"x24"	337.75	352.60	337.75	352.60
54"x24"x24"	353.65	369.05	353.65	369.05

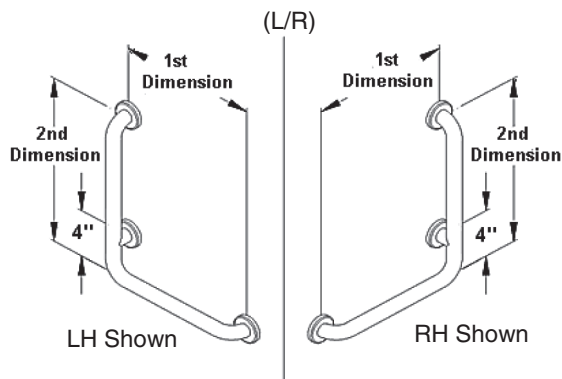
**H & H SERIES - SATIN STAINLESS - STANDARD GRAB BARS****MADE IN THE USA****"V" VERTICAL ANGLE BARS \*(LH or RH)**

Length	QEW	HEW	QCR	HCR
16"x16"	115.85	136.70	115.85	136.70
20"x20"	118.05	139.00	118.05	139.00
24"x24"	122.40	140.85	122.40	140.85
30"x30"	134.85	159.75	134.85	159.75
16"x32"	122.40	140.85	122.40	140.85

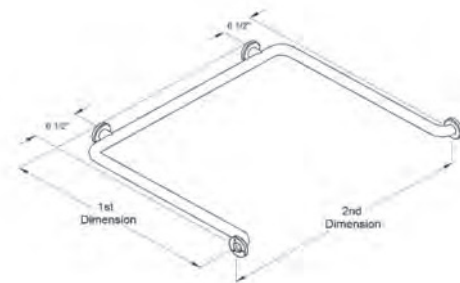
**"U" U-SHAPED SHOWER BARS**

Length	QEW	HEW	QCR	HCR
30"x36"x30"	294.95	310.65	294.95	310.65
30"x48"x30"	310.65	324.40	310.65	324.40
30"x54"x30"	324.45	340.15	324.45	340.15
30"x60"x30"	343.95	359.90	343.95	359.90

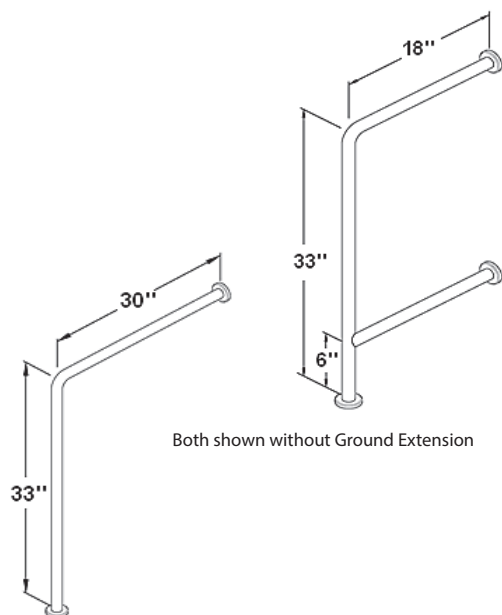

Both shown without Ground Extension

**"D" DRINKING FOUNTAIN BAR - W/O GRND EXT.**

Length	QEW	HEW	QCR	HCR
33"x18"	172.25	184.50	172.25	184.50

**"D" DRINKING FOUNTAIN BAR-W/GRND EXT.**

Length	QEW	HEW	QCR	HCR
33"x18"	184.25	196.50	184.25	196.50

**"W" WALL-2-FLOOR BAR-W/O GRND EXT.**

Length	QEW	HEW	QCR	HCR
33"x30"	133.60	157.20	133.60	157.20

**"W" WALL-2-FLOOR BAR - W/GRND EXT.**

Length	QEW	HEW	QCR	HCR
33"x30"	145.60	169.20	145.60	169.20

**WALL-2-FLOOR BARS with Side Leg (LH) or (RH)**

Length	QEW	HEW	QCR	HCR
33"x30"	222.10	246.25	222.10	246.25
33"x30"	222.10	246.25	222.10	246.25

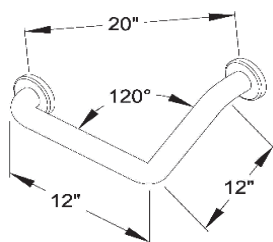
**STANDARD SERIES - SATIN STAINLESS - STANDARD GRAB BARS****MADE IN THE USA****BOOMERANG**

Length	QEW	HEW	QCR	HCR
12"x12"	75.35	82.25	75.35	82.25

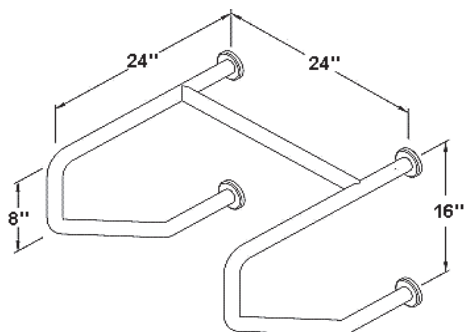
**WALL TO WALL STRADDLE**

Length	QEW	HEW	QCR	HCR
24"x24"	380.30	397.30	380.30	397.30

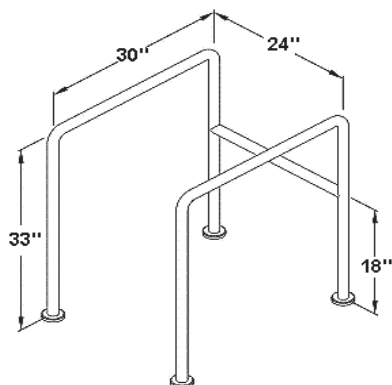
**FLOOR TO FLOOR STRADDLE**

Length	QEW	HEW	QCR	HCR
33"x30"	527.80	551.40	527.85	551.40

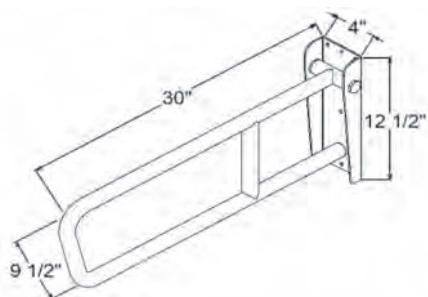
**SWING-UP GRAB BAR - 30" OVERALL**

Length	Q-SS
30" X 9.5"	145.00

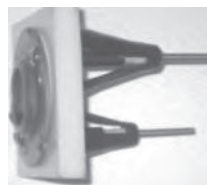
WINGIT FASTENERS

RESGBW35



GBW40

GRAB BARS: ADDITIONAL ITEMSGRAB BAR WINGIT FASTENER (**RESGBW35**)COMMERCIAL STANDARD GRAB BAR WINGIT FASTENER (**GBW40**)

SIDE LEG SUPPORT

QCR/HCR WALL MOUNT SUPPORT - GRAB BARS

STAINLESS STEEL WELDED END CAPS

LIST PRICE

\$25.75 PAIR

\$59.00 EACH

\$75.00 EACH

\$55.00 EACH

\$32.00 EACH

## STANDARD SERIES - DECORATIVE FINISHES STAINLESS - STANDARD GRAB BARS

MADE IN THE USA

POLISHED STAINLESS  
"SGX" SERIES

## "Q" 1-1/4" TUBE DIAMETER

Size	List
<b>"S" STRAIGHT</b>	
12"	57.00
16"	65.00
18"	69.55
24"	82.00
30"	94.85
32"	100.75
36"	108.55
42"	121.80
48"	133.50
<b>"T" TUB &amp; SHOWER</b>	
16"x16"	149.25
16"x32"	173.50
24"x24"	173.50
20"x40"	202.45
24"x36"	202.45
24"x48"	229.60
30"x30"	202.45
36"x36"	229.60
36"x48"	259.35
36"x54"	272.70
<b>"V" VERTICAL ANGLE (L or R)</b>	
16"x16"	149.25
20"x20"	161.30
24"x24"	173.50
30"x30"	202.45
16"x32"	173.50

## "H" 1-1/2" TUBE DIAMETER

Size	List
<b>"S" STRAIGHT</b>	
12"	60.70
16"	67.35
18"	71.90
24"	86.95
30"	98.65
32"	104.95
36"	113.95
42"	125.90
48"	139.70
<b>"T" TUB &amp; SHOWER</b>	
16"x16"	168.75
16"x32"	199.50
24"x24"	199.50
20"x40"	225.75
24"x36"	225.75
24"x48"	252.85
30"x30"	225.75
36"x36"	252.90
36"x48"	278.60
36"x54"	291.40
<b>"V" VERTICAL ANGLE (L or R)</b>	
16"x16"	168.75
20"x20"	180.90
24"x24"	199.50
30"x30"	225.75
16"x32"	199.50

PEENED with SATIN ENDS  
"SGY" SERIES

## "Q" 1-1/4" TUBE DIAMETER

Size	List
<b>"S" STRAIGHT</b>	
12"	43.50
16"	48.30
18"	50.95
24"	58.00
30"	65.90
32"	69.75
36"	74.10
42"	82.10
48"	88.60
<b>"T" TUB &amp; SHOWER</b>	
16"x16"	122.70
16"x32"	136.40
24"x24"	136.40
20"x40"	156.60
24"x36"	156.60
24"x48"	175.45
30"x30"	156.60
36"x36"	175.45
36"x48"	196.00
36"x54"	205.70
<b>"V" VERTICAL ANGLE (L or R)</b>	
16"x16"	122.70
20"x20"	137.60
24"x24"	136.40
30"x30"	156.60
16"x32"	136.40

## "H" 1-1/2" TUBE DIAMETER

Size	List
<b>"S" STRAIGHT</b>	
12"	46.80
16"	50.30
18"	53.10
24"	62.65
30"	69.30
32"	73.65
36"	79.05
42"	85.86
48"	94.30
<b>"T" TUB &amp; SHOWER</b>	
16"x16"	141.30
16"x32"	154.60
24"x24"	154.60
20"x40"	178.80
24"x36"	178.80
24"x48"	197.40
30"x30"	178.80
36"x36"	197.40
36"x48"	214.85
36"x54"	223.60
<b>"V" VERTICAL ANGLE (L or R)</b>	
16"x16"	141.30
20"x20"	148.10
24"x24"	154.60
30"x30"	178.80
16"x32"	154.60

PEENED with POLISHED ENDS  
"SGZ" SERIES

## "Q" 1-1/4" TUBE DIAMETER

Size	List
<b>"S" STRAIGHT</b>	
12"	49.95
16"	54.60
18"	58.00
24"	64.35
30"	72.80
32"	76.10
36"	80.40
42"	87.85
48"	93.75
<b>"T" TUB &amp; SHOWER</b>	
16"x16"	134.00
16"x32"	153.30
24"x24"	153.30
20"x40"	177.70
24"x36"	177.70
24"x48"	200.90
30"x30"	177.70
36"x36"	200.90
36"x48"	225.40
36"x54"	237.25
<b>"V" VERTICAL ANGLE (L or R)</b>	
16"x16"	134.00
20"x20"	143.60
24"x24"	153.30
30"x30"	177.70
16"x32"	153.30

## "H" 1-1/2" TUBE DIAMETER

Size	List
<b>"S" STRAIGHT</b>	
12"	52.60
16"	56.55
18"	60.10
24"	68.80
30"	76.10
32"	79.65
36"	86.40
42"	91.20
48"	98.90
<b>"T" TUB &amp; SHOWER</b>	
16"x16"	152.40
16"x32"	171.45
24"x24"	171.45
20"x40"	199.90
24"x36"	199.90
24"x48"	222.75
30"x30"	199.90
36"x36"	222.75
36"x48"	244.20
36"x54"	255.00
<b>"V" VERTICAL ANGLE (L or R)</b>	
16"x16"	152.40
20"x20"	162.20
24"x24"	171.45
30"x30"	199.90
16"x32"	171.45

**STANDARD SERIES - POLISHED BRASS - POWDER COAT - STANDARD GRAB BARS****MADE IN THE USA****POLISHED BRASS  
"GB SERIES"****"Q" 1-1/4" TUBE DIAMETER**

Size	List
<b>"S" STRAIGHT</b>	
12"	92.90
16"	86.90
18"	89.45
24"	102.35
30"	114.45
32"	117.30
36"	128.80
42"	146.65
48"	178.10
<b>"T" TUB &amp; SHOWER</b>	
16"x16"	187.85
16"x32"	243.50
24"x24"	243.50
20"x40"	313.15
24"x36"	313.15
24"x48"	375.70
30"x30"	313.15
36"x36"	375.70
36"x48"	438.40
36"x54"	466.15
<b>"V" VERTICAL ANGLE (L or R)</b>	
16"x16"	187.85
20"x20"	215.70
24"x24"	243.50
30"x30"	313.15
16"x32"	243.50

**POWDER COATED STAINLESS  
"GP SERIES"****"Q" 1-1/4" TUBE DIAMETER**

Size	List
<b>"S" STRAIGHT</b>	
12"	56.25
16"	60.50
18"	63.35
24"	71.80
30"	80.25
32"	83.10
36"	87.25
42"	94.35
48"	102.65
<b>"T" TUB &amp; SHOWER</b>	
16"x16"	125.50
16"x32"	144.10
24"x24"	144.10
20"x40"	167.70
24"x36"	167.70
24"x48"	190.15
30"x30"	167.70
36"x36"	190.15
36"x48"	213.45
36"x54"	224.45
<b>"V" VERTICAL ANGLE (L or R)</b>	
16"x16"	125.50
20"x20"	134.75
24"x24"	144.10
30"x30"	167.70
16"x32"	144.10

**"H" 1-1/2" TUBE DIAMETER**

Size	List
<b>"S" STRAIGHT</b>	
12"	63.10
16"	68.80
18"	71.65
24"	90.30
30"	94.05
32"	96.15
36"	100.40
42"	107.55
48"	116.05
<b>"T" TUB &amp; SHOWER</b>	
16"x16"	141.95
16"x32"	160.20
24"x24"	160.20
20"x40"	187.50
24"x36"	187.50
24"x48"	209.80
30"x30"	187.50
36"x36"	209.85
36"x48"	230.15
36"x54"	240.40
<b>"V" VERTICAL ANGLE (L or R)</b>	
16"x16"	141.95
20"x20"	147.50
24"x24"	160.20
30"x30"	187.50
16"x32"	160.20

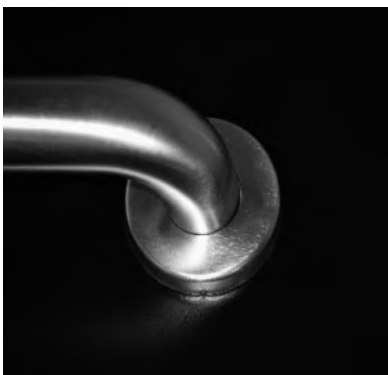
**POWDER COAT (PC) OPTIONS:**

AL = Almond

AW = Almond Wrinkle

BI = Biscuit

BK = Black

BR = Bronze

MB = Matte Black

PB = Polished Brass

SN = Satin Nickel

WT = White

WW = White Wrinkle

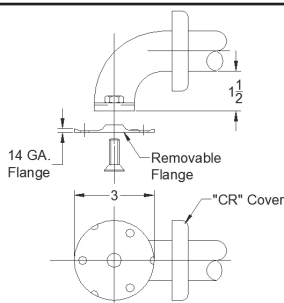
**CB****STANDARD SERIES - CUSTOM GRAB BARS**

H&H can manufacture your custom size grab bar in any number of configurations, sizes, and finishes. Please contact H&H and speak with an Account Manager for information on pricing and lead times. All custom grab bars are manufactured to meet Federal Specification and ADA Requirements.

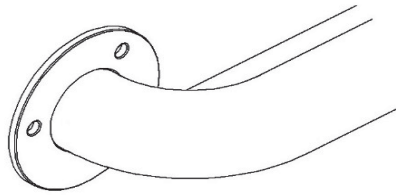

**STANDARD SERIES - INSTITUTIONAL LIGATURE RESISTANT GRAB BARS****MADE IN THE USA****LIGATURE RESISTANT GRAB BARS - CONTINUOUS WELD****HEW Configuration**

Length	HEW	HEO
16"	115.40	113.75
18"	122.70	121.05
24"	148.05	146.40
30"	170.00	168.40
32"	176.45	174.80
36"	193.55	193.70
42"	217.35	215.70
48"	246.10	244.40

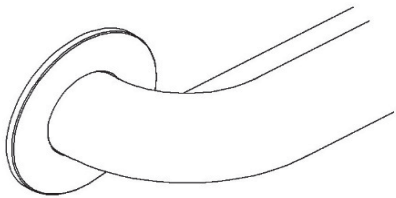
**HEO Configuration****LIGATURE RESISTANT GRAB BARS - STITCH WELD**

Length	HEW	HEO
16"	105.00	103.35
18"	110.25	108.60
24"	127.35	125.65
30"	141.00	139.35
32"	148.35	146.70
36"	153.90	152.25
42"	175.90	174.25
48"	204.60	202.90

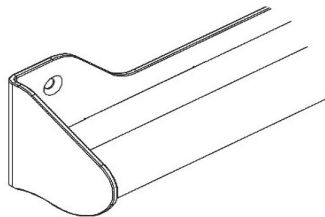
**QWB Configuration****LIGATURE RESISTANT GRAB BARS - FLANGELESS BRACKET - STITCH WELD**

Length	QWB
16"	136.15
18"	144.80
24"	174.70
30"	200.65
32"	208.20
36"	228.40
42"	256.50
48"	290.35

**STANDARD SERIES - COPPER ALLOY GRAB BARS****MADE IN THE USA**

H&H Copper Alloy Grab Bars are manufactured using CuVerro® Bactericidal Copper surfaces. CuVerro® surfaces kill bacteria that cause infections and is an effective supplement to existing infection control practices. CuVerro® is EPA-registered and is 100% recyclable made from post and pre-consumer materials. Available in both satin and peened finishes. Please allow 6 to 8 weeks for fabrication. Custom sizes and configurations are available.

**COPPER ALLOY GRAB BARS - MANUFACTURED WITH CUVERRO®**

Length	Description	QCR	HCR
12"	12" Straight Grab Bar, CuVerro® antimicrobial copper alloy	154.72	160.90
18"	18" Straight Grab Bar, CuVerro® antimicrobial copper alloy	185.60	193.00
24"	24" Straight Grab Bar, CuVerro® antimicrobial copper alloy	216.48	225.15
30"	30" Straight Grab Bar, CuVerro® antimicrobial copper alloy	247.35	257.25
36"	36" Straight Grab Bar, CuVerro® antimicrobial copper alloy	278.22	289.35
42"	42" Straight Grab Bar, CuVerro® antimicrobial copper alloy	309.10	321.47
48"	48" Straight Grab Bar, CuVerro® antimicrobial copper alloy	341.05	353.58

CuVerro® is a registered trademark of GBC Metals, LLC and is used with permission.

**STANDARD SERIES - SHOWER RODS - FLANGES - SHOWER CURTAINS - CURTAIN RINGS****1" OD Stainless Steel Shower Rods**

----Finish Options---

#304 Stainless Steel Shower Rods 1" OD X .035" (20 gauge) Wall	PS	PC
36" Straight	19.05	---
48" Straight	22.90	---
60" Straight	28.55	---
72" Straight	38.15	---

#304 Stainless Steel Shower Rods 1" OD X .049" (18 gauge) Wall	SS	PS	PC
36" Straight	22.25	24.70	44.15
48" Straight	26.65	31.10	51.00
60" Straight	33.30	38.85	60.60
72" Straight	44.25	51.60	73.15



Shower Rod Flanges for 1" Diameter Rods	SS	PS	PC
Concealed Flange & Hanger, 2-1/2" Diameter, Triple Chrome Plated Steel	3.25	3.25	7.30
Exposed Screw, 2-1/4" Diameter, Chrome Plated Zamac	---	6.50	---
Exposed Flange, 22 Gauge x 1/2" Deep Stainless Steel, 3" Diameter	9.00	9.45	14.90
Adjustable Jiffy-On, Polished Aluminum Finish	---	6.75	---
Adjustable Jiffy-On, Chrome Plated Plastic	---	2.05	2.85
Concealed Flange, 22 Gauge Snap-On Cover, 3" Diameter	15.60	18.20	25.90

**1-1/4" OD Stainless Steel Shower Rods**

#304 Stainless Steel Shower Rods 1-1/4" OD x .049" (18 gauge) Wall	SS	PS	PC
36" Straight	27.75	32.75	50.90
48" Straight	33.35	39.30	59.10
60" Straight	46.80	46.80	70.70
72" Straight	51.00	60.15	81.50



Shower Rod Flanges for 1-1/4" Diameter Rods	SS	PS	PC
Exposed Flange, 22 Gauge x 1/2" Deep Stainless Steel, 3" Diameter	7.90	9.25	14.65
Concealed Flange, 22 Gauge Snap-On Cover, 3" Diameter	16.10	18.50	25.40

**CALL FOR PRICE & AVAILABILITY ON CUSTOM SIZES**

**STANDARD SERIES - SHOWER RODS - FLANGES - SHOWER CURTAINS - CURTAIN RINGS****----Finish Options---**

<b>Curved Chrome Shower Rod Kit 1" OD X .025" Wall</b>	<b>PS</b>	<b>PC</b>
60" Curved Shower Rod Set (Includes Pivoting Flange), Polished Chrome	80.90	---

<b>#304 Stainless Steel Curved Shower Rods 1" OD X .035" (20 gauge) Wall</b>	<b>PS</b>	<b>PC</b>
60" Curved ( use Pivoting or Fixed Flanges)	42.10	---
72" Curved ( use Pivoting or Fixed Flanges)	50.15	---

<b>#304 Stainless Steel Curved Shower Rods 1" OD X .049" (18 gauge) Wall</b>	<b>SS</b>	<b>PS</b>	<b>PC</b>
60" Curved ( use Pivoting or Fixed Flanges)	42.50	47.30	91.25
72" Curved ( use Pivoting or Fixed Flanges)	53.25	59.20	98.40

<b>Shower Rod Flanges for 1" Diameter Curved Shower Rods</b>	<b>SS</b>	<b>PS</b>	<b>PC</b>
Pivoting Flange (for 1" Curved Rod) - #304 Stainless	28.60	31.75	---
Fixed Flange (for 1" Curved Rod) - #304 Stainless	22.15	24.60	32.75



<b>#304 Stainless Steel L-Shaped Shower Rods 1" OD X .049" (18 gauge) Wall</b>	<b>SS</b>	<b>PS</b>	<b>PC</b>
60"x 36" L-Shape Rod with Welded Concealed Flanges (use Ceiling Support)	122.00	135.55	181.45
72"x 36" L-Shape Rod with Welded Concealed Flanges (use Ceiling Support)	127.10	141.25	189.10

<b>Shower Rod Ceiling Support for 1" Diameter L-Shaped Shower Rods</b>	<b>SS</b>	<b>PS</b>	<b>PC</b>
Ceiling Support (for 1" L-Shaped Rod) 24" Hanger with J-Hook	29.00	32.25	50.10

<b>Shower Curtains (Heavy Duty 0.010" White Vinyl)</b>		
Heavy-Duty 48" x 72" White Curtain with Brass/Nickel Grommets on 6" Centers, Un-Weighted	36.60	---
Heavy-Duty 72" x 72" White Curtain with Brass/Nickel Grommets on 6" Centers, Un-Weighted	49.35	---
<b>Shower Curtain Rings</b>		
Curtain Ring, Nickel Plated (ea.)	0.85	---
Curtain Ring, Stainless Steel (ea.)	1.15	---

**CALL FOR PRICE & AVAILABILITY ON CUSTOM SIZES**

**STANDARD SERIES - ADA REVERSIBLE SHOWER TRANSFER SEATS****MADE IN THE USA****ADA REVERSIBLE TRANSFER SHOWER SEATS**

The H&H Reversible Transfer Shower Seat is available in both the Yoke style in 4 widths and the Swing Down Leg style in 5 widths. These seats allow for maximum flexibility when ordering. All H&H Reversible Shower Seats are fabricated using patented Lift-Assit Technology (Patent # US9,844,272,B1).

**SEAT TOP MATERIAL OPTIONS**

PAS	Phenolic Almond One-Piece Solid
PTS	Phenolic Teak One-Piece Solid
PWS	Phenolic White One-Piece Solid

All H&H seats meet Federal Specification WW-P-541/8b and all ADA code requirements (250 lbs. of force) when properly installed.

For EXTRA HEAVY load requirements select Swing Down Leg Models which have been tested to withstand 1,000 lbs. of force when properly installed.

**FEATURES**

- One Piece welded frame ensures durability
- Seat top is countersunk on both sides
- Available in 3 seat top colors
- Seat top comes unattached for easy installation

All H&H seats meet ADA Code Operation 309.4 which requires 5 lbs. of force or less to lift the seat.

**REVERSIBLE TRANSFER SEATS ( PAS, PTS or PWS ONLY)**

Description	Cube	Lbs	PAS / PTS / PWS
LH/RH L-Shaped Shower Seat 26" x 22.5"	3.31	24	390.55
LH/RH L-Shaped Shower Seat 28" x 22.5"	3.31	24	401.20
LH/RH L-Shaped Shower Seat 32" x 22.5"	3.31	25	413.25
LH/RH L-Shaped Shower Seat 34.5" x 22.5"	3.31	27	445.70

**REVERSIBLE TRANSFER SEATS WITH SWING DOWN LEGS (PAS, PTS or PWS ONLY)**

Description	Cube	Lbs	PAS / PTS / PWS
LH/RH L-Shaped Shower Seat (with swing down legs) 26" x 22.5"	3.22	26	482.50
LH/RH L-Shaped Shower Seat (with swing down legs) 28" x 22.5"	3.22	27	493.85
LH/RH L-Shaped Shower Seat (with swing down legs) 32" x 22.5"	3.22	28	505.20
LH/RH L-Shaped Shower Seat (with swing down legs) 34.5" x 22.5"	3.22	30	531.15
LH/RH L-Shaped Shower Seat (with swing down legs) 42" x 22.5"	3.22	32	663.65

**STANDARD SERIES - ACCESSIBILITY SEATS****MADE IN THE USA****SEAT TOP MATERIAL OPTIONS**

NA	Naugahyde Almond Cushion
NW	Naugahyde White Cushion
PA	Phenolic Almond 3" Slats
PT	Phenolic Teak 3" Slats
PW	Phenolic White 3" Slats
PAS	Phenolic Almond One-Piece Solid
PTS	Phenolic Teak One-Piece Solid
PWS	Phenolic White One-Piece Solid
HW	White HDPE One-Piece Solid

All H&H seats meet Federal Specification WW-P-541/8b and all ADA code requirements (250 lbs. of force) when properly installed.

For EXTRA HEAVY load requirements, select Swing Down Leg Models, which have been tested to withstand 1,000 lbs. of force when properly installed

All H&H seats meet ADA Code Operation 309.4 which requires 5 lbs. of force or less to lift the seat.

**H&H CAN MANUFACTURE CUSTOM SIZE SEATS TO MEET ANY NEED - CONTACT US FOR INFORMATION**

**BENCH SEATS**

----- Seat Top Material Options -----

Description	Cube	Lbs	NA / NW	PA / PT PW	PAS / PTS PWS / HW
Bench Style Shower Seat 18" x 15"	3.31	16	324.70	389.45	389.45
Bench Style Shower Seat 22" x 15"	3.31	18	359.90	425.70	425.70
Bench Style Shower Seat 24" x 15"	3.31	19	378.10	442.75	442.75
Bench Style Shower Seat 28" x 15"	3.31	20	407.60	472.25	472.25
Bench Style Shower Seat 30" x 15"	3.31	21	425.70	501.80	501.80
Bench Style Shower Seat 32" x 15"	3.31	22	442.75	520.00	520.00

**TRANSFER SEATS**

----- Seat Top Material Options -----

Description	Cube	Lbs	NA / NW	PA / PT PW	PAS / PTS PWS / HW
LH L-Shaped Shower Seat 26" x 22.5"	3.31	24	454.10	506.30	506.30
RH L-Shaped Shower Seat 26" x 22.5"	3.31	24	454.10	506.30	506.30
LH L-Shaped Shower Seat 28" x 22.5"	3.31	24	466.55	518.20	518.25
RH L-Shaped Shower Seat 28" x 22.5"	3.31	24	466.55	518.20	518.25
LH L-Shaped Shower Seat 32" x 22.5"	3.31	25	479.10	530.15	530.15
RH L-Shaped Shower Seat 32" x 22.5"	3.31	25	479.10	530.15	530.15

**H&H SHOWER AND TUB SEATS MEETS ALL REQUIREMENTS FOR ADA COMPLIANCE.**

**INCLUDING ADA CODE 309.4 WHICH REQUIRES 5 LBS. OF FORCE OR LESS TO LIFT THE SEAT.**

**STANDARD SERIES - ACCESSIBILITY SEATS****MADE IN THE USA****BENCH SEATS WITH SWING DOWN LEGS**

----- Seat Top Material Options -----

Description	Cube	Lbs	NA / NW	PA / PT PW	PAS / PTS PWS / HW
Bench Style Shower Seat (with swing down legs) 18" x 15"	3.31	19	447.15	492.75	492.75
Bench Style Shower Seat (with swing down legs) 22" x 15"	3.31	20	485.90	523.15	523.15
Bench Style Shower Seat (with swing down legs) 24" x 15"	3.31	22	504.10	541.35	541.35
Bench Style Shower Seat (with swing down legs) 28" x 15"	3.31	26	535.60	571.40	571.40
Bench Style Shower Seat (with swing down legs) 30" x 15"	3.31	27	554.95	595.70	595.70
Bench Style Shower Seat (with swing down legs) 32" x 15"	3.31	28	573.20	620.00	620.00
Bench Style Shower Seat (with swing down legs) 42" x 20"	8.00	39	754.00	---	922.70
Bench Style Shower Seat (with swing down legs) 48" x 24"	8.00	53	962.85	---	1086.00

**TRANSFER SEATS WITH SWING DOWN LEGS**

----- Seat Top Material Options -----

Description	Cube	Lbs	NA / NW	PA / PT PW	PAS / PTS PWS / HW
LH L-Shaped Shower Seat (with swing down legs) 26" x 22.5"	3.22	26	559.90	614.20	614.20
RH L- Shaped Shower Seat (with swing down legs) 26" x 22.5"	3.22	26	559.90	614.20	614.20
LH L- Shaped Shower Seat (with swing down legs) 28" x 22.5"	3.22	27	571.40	625.75	625.75
RH L- Shaped Shower Seat (with swing down legs) 28" x 22.5"	3.22	27	571.40	625.75	625.75
LH L- Shaped Shower Seat (with swing down legs) 32" x 22.5"	3.22	28	584.10	637.30	637.30
RH L- Shaped Shower Seat (with swing down legs) 32" x 22.5"	3.22	28	584.10	638.30	637.30
LH L-Shaped Shower Seat (with swing down legs) 36" x 22.5"	3.22	32	596.70	652.00	652.00
RH L-Shaped Shower Seat (with swing down legs) 36" x 22.5"	3.22	32	596.70	652.00	652.00
LH L-Shaped Shower Seat (with swing down legs) 42" x 22.5"	3.22	38	615.60	---	675.30
RH L-Shaped Shower Seat (with swing down legs) 42" x 22.5"	3.22	38	615.60	---	675.30

**H&H SHOWER AND TUB SEATS MEETS ALL REQUIREMENTS FOR ADA COMPLIANCE.****INCLUDING ADA CODE 309.4 WHICH REQUIRES 5 LBS. OF FORCE OR LESS TO LIFT THE SEAT.**

**STANDARD SERIES - ACCESSIBILITY SEATS****MADE IN THE USA****SEAT TOP MATERIAL OPTIONS**

NA	Naugahyde Almond Cushion
NW	Naugahyde White Cushion
PA	Phenolic Almond 3" Slats
PT	Phenolic Teak 3" Slats
PW	Phenolic White 3" Slats
PAS	Phenolic Almond One-Piece Solid
PTS	Phenolic Teak One-Piece Solid
PWS	Phenolic White One-Piece Solid
MW	Blow Molded White HDPE Plastic
SS	Satin Stainless Steel

All H&H seats meet Federal Specification WW-P-541/8b and all ADA code requirements (250 lbs. of force) when properly installed.

**TUB SEATS**

----- Seat Top Material Options -----

Description	Cube	Lbs	MW	NA / NW	PA / PT PW	PAS / PTS PWS
End-Hung Folding Tub Seat, 32" x 13.5" Frameless	2.13	13	----	----	----	327.90
End-Hung Folding Tub Seat, 32" x 13.5" with SS Frame	2.13	16	----	354.50	447.40	----
End-Hung Folding Tub Seat, 32" x 16" Frameless	2.20	17	----	---	----	344.90
End-Hung Folding Tub Seat, 32" x 16" with SS Frame	2.20	20	----	342.00	----	----
Rear-Hung Folding Tub Seat, 29" x 16.5" Frameless	2.13	16	----	---	----	354.50
Rear-Hung Folding Tub Seat, 29" x 16.5" with SS Frame	2.13	19	----	381.00	474.00	----
End-Hung Tri-Fold, Removable TubSeat, 29" x 15"	2.13	12	169.85	---	----	----

**PORTABLE TUB SEATS**

Description	Cube	Lbs	MW	NA / NW	PA / PT PW	PAS / PTS PWS
Edge - Mounted Portable Tub Seat, 26.5" x 16"	2.13	14	---	---	---	392.30
Edge - Mounted Portable Tub Seat with Dual Fold Down Adjustable Legs, 43.5" x 15"	4.00	25	----	----	----	656.80
Edge - Mounted Portable Tub Seat with Dual Clamps and Quick-Release Pin, 26.5" x 15"	2.50	20	---	---	---	601.50

**H&H SHOWER AND TUB SEATS MEETS ALL REQUIREMENTS FOR ADA COMPLIANCE.**

**INCLUDING ADA CODE 309.4 WHICH REQUIRES 5 LBS. OF FORCE OR LESS TO LIFT THE SEAT.**



**STANDARD SERIES - ACCESSIBILITY SEATS****MADE IN THE USA****SEAT TOP MATERIAL OPTIONS**

PAS	Phenolic Almond One-Piece Solid
PTS	Phenolic Teak One-Piece Solid
PWS	Phenolic White One-Piece Solid
SS	Satin Stainless Steel



H&H Institutional, Bariatric and Stationary Bench Seats have been tested to withstand over 1,500 lbs. of when properly installed

**INSTITUTIONAL, BARIATRIC & STATIONARY BENCH SEATS**

----- Seat Top Material Options -----

Description	Cube	Lbs	Stainless Steel (SS)	PAS / PTS PWS
LH Transfer Seat (with Dual Yoke), 32" x 22.5" One-Piece Stainless Steel Seat Top	3.31	32	1,287.25	----
RH Transfer Seat (with Dual Yoke), 32" x 22.5" One-Piece Stainless Steel Seat Top	3.31	32	1,287.25	----
Bench Seat (with Dual Yoke), 32" x 15" One-Piece Stainless Steel Seat Top	3.31	32	1,287.25	----
Bariatric Bench Seat (with swing down legs), 36" x 18"	7.00	40	---	930.45
Stationary Bench Seat (with Back Rest), 42" x 20"	-----	125	---	1,181.25
Stationary Bench Seat (with Back Rest), 48" x 24"	-----	145	---	1,352.40

**ACCESSIBILITY SEATS - ADDITIONAL ITEMS**

Description	Price	Description	Price
Powder Coat (PC) Seat Frame	Add 230.00	Slide / Guide Bracket for Wall Mount Seats, Stainless Steel, Each (with hardware)	23.40
Polished Stainless (PS) Seat Frame	Add 290.00	#10 x 2 1/2" Stainless Steel mounting screws for Grab Bars and /or #12 x 2 1/2" Stainless Steel mounting screws for Seats. Each pack contains 6 mounting screws.	2.30
1" Threaded Seat Leg Bolt (Standard Leveling Foot) Stainless Steel / Black, Each	7.00	Wall - Mount Support Hook Stainless Steel, Each	35.50
3" Seat Leg Support Flange with Threaded Stud (Leveling Foot), Stainless Steel / Black, Each	27.50		
<b>REPLACEMENT SEAT TOPS - BENCH SEATS</b>		<b>REPLACEMENT SEAT TOPS - TRANSFER SEATS</b>	
<b>NA/NW CUSHION</b>		<b>NA/NW CUSHION</b>	
18" - 22" - 24" Wide x 13.5"	190.00	26" - 28" - 32" Wide x 21"	235.00
28" - 30" - 32" Wide x 13.5"	220.00		
<b>PAS/PWS/PTS PHENOLIC One-PIECE SOLID</b>		<b>PAS/PWS/PTS PHENOLIC One-PIECE SOLID</b>	
18" - 22" - 24" Wide x 13.5"	210.00	26" - 28" - 32" Wide x 21"	245.00
28" - 30" - 32" Wide x 13.5"	230.00		
		<b>CUSTOM "WAVE" SLOTS</b>	Add 45.00

**ACCESSIBILITY SEATS - ADDITIONAL NOTES**

H&H RECOMMENDS THAT ALL ACCESSIBILITY SEATS, AS WELL AS GRAB BARS, BE INSTALLED USING 2" MINIMUM THICKNESS "IN-WALL" SOLID WOOD BACKING MATERIAL WITH THE APPROPRIATE STAINLESS STEEL, PHILLIPS HEAD SCREWS (INCLUDED).



**DESIGNERS SERIES - SHOWER SEAT****MADE IN THE USA****FRAME FINISH OPTIONS**

PC Powder Coat

**SEAT TOP MATERIAL OPTIONS**

PWS	Phenolic White One-Piece Solid
PAS	Phenolic Almond One-Piece Solid
PTS	Phenolic Teak One-Piece Solid

**SEAT DESIGN OPTIONS**

S	Standard Drain Slots
C	Champagne Drain Slots
L	Lotus Drain Slots

**POWDER COAT (PC) OPTIONS**

AL = Almond  
 AW = Almond Wrinkle  
 BI = Biscuit  
 BK = Black  
 BR = Bronze  
 MB = Matte Black  
 PB = Polished Brass  
 SL = Silver  
 WT = White  
 WW = White Wrinkle

**H&H Designer Shower Seats meet Federal Specification WW-P-5541/8b and all ADA code requirements (250 lbs. of force) when properly installed.  
 H&H recommends a minimum 2" of solid wood in-wall backing for all shower seat installations.**

**Designer Shower Seats feature an easy to remove back piece to allow cleaning of the shower wall behind the seat.**

**----- Frame Finish Options -----**

Description	PC
Designer Shower Seat 19-3/8" W x 15-1/2" D with 12-3/4" Backrest with 1/2" One-Piece Solid Phenolic Seat Top available in White (PWS), Almond (PAS), or Teak (PTS), Aluminum Extruded Frame / Standard Drain Slots	496.00
Designer Shower Seat 19-3/8" W x 15-1/2" D with 12-3/4" Backrest with 1/2" One-Piece Solid Phenolic Seat Top available in White (PWS), Almond (PAS), or Teak (PTS), Aluminum Extruded Frame / Champagne Drain Slots	599.90
Designer Shower Seat 19-3/8" W x 15-1/2" D with 12-3/4" Backrest with 1/2" One-Piece Solid Phenolic Seat Top available in White (PWS), Almond (PAS), or Teak (PTS), Aluminum Extruded Frame / Lotus Drain Slots	599.90

**----- Frame Finish Options -----**

Description	PC
Designer Bench Seat 19-3/8" W x 15-1/2" D with 14-3/4" Arched Backrest with 1/2" One-Piece Solid Phenolic Seat Top available in White (PWS), Almond (PAS), or Teak (PTS), Aluminum Extruded Frame / Standard Drain Slots	529.90

**THE ABOVE MODELS ARE JUST A FEW OF OUR MOST POPULAR DESIGNS  
 H&H CAN CUSTOMIZE OUR SILHOUETTE DRAIN SLOTS TO MATCH ANY DESIGN OF LOGO  
 CALL FOR A QUOTATION**

**DESIGNER SERIES - SEATS / CORNER SHOWER SHELVES****MADE IN THE USA****SEAT TOP MATERIAL OPTIONS**

PA	Phenolic Almond 3" Slats
PW	Phenolic White 3" Slats
PT	Phenolic Teak 3" Slats
PAS	Phenolic Almond One-Piece Solid
PWS	Phenolic White One-Piece Solid
PTS	Phenolic Teak One-Piece Solid

**DESIGNER & CONTOUR SHOWER SEATS / REMOVABLE TUB SEAT**

---- Seat Top Material Options ----

Description	PA / PW / PT	PAS / PWS / PTS
Designer Bench Seat, Grab Bar (Hung with Backrest and Legs) 18" W x 20-5/8" D, 1-1/4" O.D. Frame with Phenolic Almond (PA or PAS), White (PW or PWS) or Teak (PT or PTS) Seat Top Satin SS Frame - 1 each GSS-180-QCR included with each Profile Shower Seat -	526.80	526.80
Contour Shower Seat 26-1/2" W x 16-1/2" D, One-Piece Solid Phenolic Seat Top available in Almond (PAS), White (PWS), or Teak (PTS) with Standard Drain Slots, 18" Radius Clear Coated Aluminum Frame **	----	173.25
Designer Removable Tub Seat 27" x 15-1/2", One-Piece Solid Phenolic Seat Top available in Almond (PAS), White (PWS), or Teak (PTS) with Standard Drain Slots, Adjustable Stabilizing Posts Satin SS Frame	----	313.50

\*\* See matching Contour Shower Shelf below.

**FINISH OPTIONS FOR CORNER SHELVES**

SS = Satin Stainless Finish

PS = Polished Stainless Finish

PC = Powder Coat Finish

**CORNER SHOWER SHELVES**

---- Finish Options ----

---- Shelf Top Material Options ----

Description	SS	PS	PC	PAS / PWS / PTS
Corner Shower Shelf, 14-1/8" W x 8-1/2" D with 14" Handle #304 Stainless Steel	130.00	157.30	140.80	----
Corner Shower Shelf with Rail, 13-1/4" W x 6-7/8" D #304 Stainless Steel	104.50	131.00	119.45	----
Rectangular Sundries Shelf with Rail, 16" W x 6-1/8" D #304 Stainless Steel	128.65	173.00	149.65	----
Contour Shower Shelf, 12-5/8" W x 9" D, One-Piece Solid Phenolic available in Almond (PAS), White (PWS), or Teak (PTS) with Standard Drain Slots, 18" Radius Clear Coated Aluminum Frame **	----	----	----	103.90

\*\* See matching Contour Shower Seat above.

**DESIGNERS SERIES - GRAB BARS****MADE IN THE USA****FINISH OPTIONS**

SS = Satin Stainless Finish

PS = Polished Stainless Finish

PC = Powder Coat Finish

QCR = 1-1/4" O.D. Bar / Concealed Flange

HCR = 1-1/2" O.D. Bar / Concealed Flange

**POWDER COAT (PC) OPTIONS**

AL = Almond

MB = Matte Black

AW = Almond Wrinkle

PB = Polished Brass

BI = Biscuit

SN = Satin Nickel

BK = Black

WT = White

BR = Bronze

WW = White Wrinkle

**Designer Grab Bars meet Federal Specification WW-P-541/8b and all ADA code requirements (250 lbs. of force) when properly installed. H&H recommends a minimum 2" of solid wood in-wall backing for all grab bar installations**



Description	SS - QCR	SS - HCR	PS - QCR	PS-HCR	PC-QCR	PC-HCR
Wedge Bar 16" x 16"	120.75	126.25	143.80	150.40	143.80	150.40
Wave Bar 18" Overall	106.50	109.75	139.45	144.90	139.45	144.90
Wave Bar 24" Overall	109.80	115.30	143.80	150.40	143.80	150.40
Wave Bar 36" Overall	117.50	123.50	151.50	157.00	151.50	157.00
Wave Bar 48" Overall	126.25	131.80	160.25	165.75	160.25	165.75
LH Zuma Bar 16" x 11-3/4" x 16"	137.25	144.90	169.10	176.70	169.10	176.70
RH Zuma Bar 16" x 11-3/4" x 16"	137.25	144.90	169.10	176.70	169.10	176.70



Description	SS - QCR	SS - HCR	PS - QCR	PS-HCR	PC-QCR	PC-HCR
Maverick Double Arched Grab Bar 30" Overall	137.25	144.90	169.05	176.70	169.05	176.70
Crescent Grab Bar 30"	137.25	144.90	169.05	176.70	169.05	176.70



Description	SS - QCR	SS - HCR	PS - QCR	PS-HCR	PC-QCR	PC-HCR
Half-Moon Bay Curved Grab Bar with Towel Bar 30"	148.20	155.90	182.25	191.05	182.25	191.50
Newport Grab Bar with Towel Bar 30" Overall	120.75	136.20	144.90	160.25	144.90	160.25

**DESIGNER SERIES - GRAB BARS****MADE IN THE USA**

Description	SS - QCR	SS - HCR	PS - QCR	PS-HCR	PC-QCR	PC-HCR
LH Pismo Curved Grab Bar with Toilet Paper Holder 30"	153.70	159.20	183.35	193.20	183.35	193.20
RH Pismo Curved Grab Bar with Toilet Paper Holder 30"	153.70	159.20	183.35	193.20	183.35	193.20
LH Piano Curved Grab Bar with Towel Bar 30"	164.70	170.15	194.35	194.45	194.35	194.45
RH Piano Curved Grab Bar with Towel Bar 30"	164.70	170.15	194.35	194.45	194.35	194.45



Description	SS - QCR	SS - HCR	PS - QCR	PS-HCR	PC-QCR	PC-HCR
LH U-Bar with Towel Bar - 30" X 11"	137.25	----	161.40	----	161.40	----
RH U-Bar with Towel Bar - 30" X 11"	137.25	----	161.40	----	161.40	----
Shower Valve Grab Bar 12" Front Mount	126.25	----	146.00	----	153.75	----



Description	SS - QCR	SS - HCR	PS - QCR	PS-HCR	PC-QCR	PC-HCR
Swing-Up Grab Bar 30" Overall	338.10	----	466.70	----	466.70	----
Wall-To-Wall Swing-Away Grab Bar	399.65	----	535.70	----	535.70	----
Wall-To-Floor Swing-Away Grab Bar	433.65	----	576.35	----	576.35	----

**THE ABOVE MODELS REPRESENT OUR STANDARD DESIGNER SERIES  
H&H DESIGNS, ENGINEERS AND MANUFACTURES CUSTOM SIZES AND STYLES. STYLES.**

**CUSTOM FINISHES ARE AVAILABLE**

**CALL FOR QUOTATION**

**HOSPITALITY SERIES - GRAB BARS****MADE IN THE USA****FINISH OPTIONS**

SS = Satin Stainless Finish  
 PS = Polished Stainless Finish  
 PC = Powder Coat Finish

**Grab Bar Series Features:**

- \* 304 Stainless Steel
- \* Welded Construction
- \* Custom finishes and colors available
- \* 3" Round Concealed Flanges
- \* Available in decorative flange designs

**POWDER COAT (PC) OPTIONS**

AL = Almond MB = Matte Black  
 AW = Almond Wrinkle PB = Polished Brass  
 BI = Biscuit SN = Satin Nickel  
 BK = Black WT = White  
 BR = Bronze WW = White Wrinkle

**All Hospitality Series Grab Bars meet Federal Specification WW-P-541/8b for welded construction and withstanding 250 lbs. of force when properly installed.**

**HOSPITALITY SERIES**

-----Finish Options -----

Description	SS	PS	PC
18" Grab Bar, 1-1/4" O.D., Concealed Flanges	99.50	117.55	117.55
24" Grab Bar, 1-1/4" O.D., Concealed Flanges	113.05	137.85	137.85
36" Grab Bar, 1-1/4" O.D., Concealed Flanges	125.50	162.75	162.75
42" Grab Bar, 1-1/4" O.D., Concealed Flanges	145.80	191.05	191.05
18" Grab Bar, 1-1/2" O.D., Concealed Flanges	113.05	130.00	130.00
24" Grab Bar, 1-1/2" O.D., Concealed Flanges	128.85	153.95	153.95
36" Grab Bar, 1-1/2" O.D., Concealed Flanges	142.45	180.80	180.80
42" Grab Bar, 1-1/2" O.D., Concealed Flanges	167.25	212.45	212.45



-----Finish Options -----

Description	SS	PS	PC
18" Grab Bar, 1-1/4" O.D., Concealed Flanges	124.30	146.95	146.95
24" Grab Bar, 1-1/4" O.D., Concealed Flanges	141.35	162.35	162.35
36" Grab Bar, 1-1/4" O.D., Concealed Flanges	155.95	203.45	203.45
42" Grab Bar, 1-1/4" O.D., Concealed Flanges	180.80	237.35	237.35

**NOTE: ABOVE GRAB BARS AVAILABLE IN 1 1/4" O.D. ONLY****ELLIPTIC-SERIES**

-----Finish Options -----

Description	SS	PS	PC
18" Elliptic Grab Bar - Mitred Corners, 1-1/2" O.D., Concealed Flanges	142.95	163.35	163.35
24" Elliptic Grab Bar - Mitred Corners, 1-1/2" O.D., Concealed Flanges	156.50	183.65	183.65
36" Elliptic Grab Bar - Mitred Corners, 1-1/2" O.D., Concealed Flanges	169.00	208.50	208.50
42" Elliptic Grab Bar - Mitred Corners, 1-1/2" O.D., Concealed Flanges	189.30	236.75	236.75

**NOTE: ELLIPTIC-SERIES GRAB BARS AVAILABLE IN 1-1/2" O.D. ONLY****ELLIPTIC-SERIES**

-----Finish Options -----

Description	SS	PS	PC
18" Elliptic Grab Bar - 1-1/2" O.D., Concealed Flanges	131.70	152.05	152.05
24" Elliptic Grab Bar - 1-1/2" O.D., Concealed Flanges	145.20	172.40	172.40
36" Elliptic Grab Bar - 1-1/2" O.D., Concealed Flanges	157.65	197.25	197.25
42" Elliptic Grab Bar - 1-1/2" O.D., Concealed Flanges	178.00	225.50	225.50

**NOTE: ELLIPTIC-SERIES GRAB BARS AVAILABLE IN 1-1/2" O.D. ONLY**

**BATH ACCESSORIES - HOSPITALITY SERIES****MADE IN THE USA****FINISH OPTIONS**

SS = Satin Stainless Finish  
 PS = Polished Stainless Finish  
 PC = Powder Coat Finish

**Accessories Features:**

\* 3/4" Round Crosspiece  
 \* 1" Round Post  
 \* 2-1/2" Round Concealed Flanges  
 \* Available in decorative step flange design

**POWDER COAT (PC) OPTIONS**

AL= Almond MB = Matte Black  
 AW = Almond Wrinkle PB = Polished Brass  
 BI= Biscuit SN = Satin Nickel  
 BK = Black WT = White  
 BR = Bronze WW = White Wrinkle

**FABRICATED OF TYPE 304, 18-8 ALLOY, STAINLESS STEEL****RATED TO EXCEED 100 LB LOAD CAPACITY WHEN PROPERLY INSTALLED****HOSPITALITY SERIES**

-----Finish Options -----

Description	SS	PS	PC
Soap Holder (without holes), 4-5/16" Dia. Dish	51.90	57.85	57.85
Toothbrush Tumbler Holder, 4-5/16" Dia. Dish	51.90	57.85	57.85
Door Bumper, 1-1/2" Dia. x 3" D, Exposed Mounting Flange	38.60	42.35	42.35
Door Bumper / Coat Hanger, 1-1/2" Dia. x 3-1/2" D, Exposed Mounting Flange	42.40	46.70	46.70



-----Finish Options -----

Description	SS	PS	PC
18" Towel Bar Set (3/4" Rd.), 18" Mounting Centers x 3-1/2" D	76.65	84.50	84.50
18" Double Towel Bar Set (3/4" Rd.), 18" Mounting Centers x 6-3/4" D	96.55	104.40	104.40
24" Towel Bar Set (3/4" Rd.), 24" Mounting Centers x 3-1/2" D	81.70	89.70	89.70
24" Double Towel Bar Set (3/4" Rd.), 24" Mounting Centers x 6-3/4" D	102.15	110.30	110.30
30" Towel Bar Set (3/4" Rd.), 30" Mounting Centers x 3-1/2" D	87.05	95.50	95.50
36" Towel Bar Set (3/4" Rd.), 36" Mounting Centers x 3-1/2" D	94.40	103.15	103.15



-----Finish Options -----

Description	SS	PS	PC
Single Paper Holder, White Roller, 6-1/4" Mounting Centers x 3-1/2" D	73.25	79.60	79.60
Double Paper Holder, White Roller, 12-1/2" Mounting Centers x 3-1/2" D	100.45	108.95	108.95
"Post-Style" Single Paper Holder, 6" Center to End x 4-1/8" D	88.70	95.10	95.10
"Post-Style" Double Paper Holder, 11-1/2" Overall x 4-1/8" D	103.95	112.45	112.45
Rectangular Toilet Paper & Towel Holder, 6-1/2" W x 5-1/2" H x 3-3/8" D	74.85	82.10	82.10

**BATH ACCESSORIES - HOSPITALITY SERIES****FINISH OPTIONS**

SS = Satin Stainless Finish  
 PS = Polished Stainless Finish  
 PC = Powder Coat Finish

**POWDER COAT (PC) OPTIONS**

AL = Almond MB = Matte Black  
 AW = Almond Wrinkle PB = Polished Brass  
 BI = Biscuit SN = Satin Nickel  
 BK = Black WT = White  
 BR = Bronze WW = White Wrinkle



Description	-----Finish Options -----		
	SS	PS	PC
Single Robe Hook, 2-1/2" W x 2-1/2" D	47.45	51.40	51.40
Double Robe Hook, 3-1/2" W x 3-1/4" D	52.35	55.10	55.10
Towel Ring, 6-3/8" Dia. x 2-1/2" D	61.70	68.25	68.25



Description	-----Finish Options -----		
	SS	PS	PC
18" Towel Shelf and Bar, 18" Mounting Centers x 9-1/4" D	112.70	123.50	123.50
24" Towel Shelf and Bar, 24" Mounting Centers x 9-1/4" D	117.90	132.50	132.05



Description	-----Finish Options -----		
	SS	PS	PC
13-1/4" W x 6-7/8" D Triangular / Corner Shower Shelf with Rail	104.50	131.00	119.45
16" W x 6-1/8" D Rectangular Sundries Shelf with Rail	128.65	173.00	149.65

**BATH ACCESSORIES - HOSPITALITY SERIES****MADE IN THE USA****FINISH OPTIONS**

SS = Satin Stainless Finish  
 PS = Polished Stainless Finish  
 PC = Powder Coat Finish

**Accessories Features:**

- \* 7/8" round crosspiece
- \* 7/8" round post
- \* 2-1/2" round concealed flanges
- \* Available in decorative step flange design

**POWDER COAT (PC) OPTIONS**

AL= Almond MB = Matte Black  
 AW = Almond Wrinkle PB = Polished Brass  
 BI= Biscuit SN = Satin Nickel  
 BK = Black WT = White  
 BR = Bronze WW = White Wrinkle

**FABRICATED OF TYPE 304, 18-8 ALLOY, STAINLESS STEEL****RATED TO EXCEED 100 LB LOAD CAPACITY WHEN PROPERLY INSTALLED****HOSPITALITY SERIES**

Description	-----Finish Options -----		
	SS	PS	PC
Soap Dish Holder, 4-5/16" Dia. Dish	51.90	57.85	57.85
Toothbrush Holder, 4-5/16" Dia. Dish	51.90	57.85	57.85
Door Bumper, 1-1/2" Dia. x 3" D, Exposed Mounting Flange	38.30	42.35	42.35
Door Bumper/Coat Hanger, 1-1/2" Dia. x 3" D, Exposed Mounting Flange	42.40	46.70	46.70



Description	-----Finish Options -----		
	SS	PS	PC
18" Towel Bar Set, 18" Overall, 15" Mounting Centers	96.95	114.10	114.10
24" Towel Bar Set, 24" Overall, 21" Mounting Centers	104.40	122.75	122.75
30" Towel Bar Set, 30" Overall, 27" Mounting Centers	110.50	128.65	128.65
36" Towel Bar Set, 36" Overall, 33" Mounting Centers	120.50	133.10	133.10



Description	-----Finish Options -----		
	SS	PS	PC
Single Paper Holder, White Roller, 6-1/4" Mounting Centers x 3-1/2" D	73.25	79.60	79.60
Double Paper Holder, White Roller, 12-1/2" Mounting Centers x 3-1/2" D	100.45	108.95	108.95
Euro Paper Holder, 6" Center to End x 4-1/8" D	88.70	95.10	95.10
Double Euro Paper Holder, 11-1/2" Overall x 4-1/8" D	103.95	112.45	112.45
Toilet Paper Holder / Towel Ring, 6" W x 5-1/4" H x 3-3/8" D	74.85	82.10	82.10



Description	-----Finish Options -----		
	SS	PS	PC
Single Robe Hook, 2-1/2" W x 2-1/2" D	47.50	51.40	51.40
Double Robe Hook, 3-1/2" W x 3-1/4" D	52.35	55.10	55.10
Towel Ring, 6-3/8" Dia. x 2-1/2" D	61.70	68.25	68.25



**BATH ACCESSORIES - STAINLESS SERIES**

FABRICATED OF TYPE 304, 18-8 ALLOY, STAINLESS STEEL  
FOR HOTEL / MOTEL, HEALTHCARE, HOSPITALS,  
GOVERNMENT & COMMERCIAL PROJECTS

**FINISH OPTIONS**

SS = Satin Stainless Finish

PS = Polished Stainless Finish

**STAINLESS SERIES**

-----Finish Options-----

Description	Case Qty	Lbs / Case	SS	PS
Soap Holder without drain holes 4-1/4" W x 2-1/8" H x 4-1/4" D	50	22	13.95	13.95
Soap Holder with drain holes 4-1/4" W x 2-1/8" H x 4-1/4" D	50	21	13.95	13.95
Toothbrush / Tumbler Holder 4-1/4" W x 2" H x 4" D	50	18	13.95	13.95



-----Finish Options-----

Description	Case Qty	Lbs / Case	SS	PS
18" Towel Bar Set (3/4" Sq.), 18" End to End	100	75	28.35	28.35
24" Towel Bar Set (3/4" Sq.), 24" End to End	100	84	30.60	30.60
30" Towel Bar Set (3/4" Sq.), 30" End to End	100	89	33.10	33.10
18" Towel Bar Set (3/4" Rd.), 18" End to End	100	68	27.85	27.85
24" Towel Bar Set (3/4" Rd.), 24" End to End	100	75	29.00	29.00
30" Towel Bar Set (3/4" Rd.), 30" End to End	100	82	30.35	30.35
24" Towel Shelf with Bar, 24" End to End x 8-3/4" D	20	41	65.25	65.25



-----Finish Options-----

Description	Case Qty	Lbs / Case	SS	PS
Single Paper Holder, Plastic Spring Loaded White Roller, 7-1/2" W x 2" H x 3-7/8" D	60	35	22.25	22.25
Double Paper Holder, Plastic Spring Loaded White Roller, 13" W x 2" H x 3-7/8" D	40	34	29.80	29.40
Single Robe Hook, 2" W x 1-9/16" D	50	11	9.00	9.00
Double Robe Hook, 4" W x 1-3/4" D	50	15	9.95	9.95
Towel Pin, 2" W x 4-1/2" D	50	16	9.45	9.45
Hat and Robe Hook, 2" W x 6-1/4" H x 4" D	50	24	----	25.20
Towel Ring, 5-3/8" Dia. x 2-3/8" D	50	22	13.45	20.70

**BATH ACCESSORIES - CONTEMPORARY SERIES / ECONOMY SERIES****CONTEMPORARY SERIES**

Description	Die Cast Zinc Alloy Chrome Plated
Double Robe Hook, 2-3/8" W x 1-3/4" D, Concealed Screw Mounting	4.20
Single Paper Holder with Plastic Spring Loaded Chrome Roller, 7-1/2" W x 3" D, Concealed Screw Mounting	9.00
Single Paper Holder with Plastic Spring Loaded White Roller, 7-1/2" W x 3" D, Concealed Screw Mounting	7.65
18" Towel Bar Set (3/4" Sq.), 18" Mounting Centers x 3" D, Concealed Screw Mounting	9.35
24" Towel Bar Set (3/4" Sq.), 24" Mounting Centers x 3" D, Concealed Screw Mounting	10.55
30" Towel Bar Set (3/4" Sq.), 30" Mounting Centers x 3" D, Concealed Screw Mounting	10.55
Wall Mounted Toothbrush Holder, 4-1/4" W x 3-1/4" D, Concealed Screw Mounting	5.15
Wall Mounted Soap Holder, 4-1/4" W x 3-1/4" D, Concealed Screw Mounting	6.15
Towel Ring with Clear Acrylic Ring, 6" Dia. x 3-3/8" D, Concealed Screw Mounting	7.45
Towel Ring with Aluminum Ring, 6" Dia. x 3-3/8" D, Concealed Screw Mounting	8.75

**ECONOMY SERIES**

Description	Die Cast Zinc Alloy Chrome Plated
Metal Single Robe Hook, 1-3/8" Mounting Centers x 1-1/2" D, Exposed Screw Mounting	2.75
Metal Paper Holder with Plastic Spring Loaded White Roller, 1-1/4" Mounting Centers x 2-3/4" D, Exposed Screw Mounting	5.35
Metal 5/8" Square Towel Bar Posts Only, 1-1/4" Mounting Centers x 2-3/4" D, Exposed Screw Mounting (Pair)	4.95
18" Towel Bar Set (5/8" Sq.), 18" Mounting Centers x 2-3/4" D, Exposed Screw Mounting	7.25
24" Towel Bar Set (5/8" Sq.), 24" Mounting Centers x 2-3/4" D, Exposed Screw Mounting	7.90
Metal Toothbrush Holder, 3-7/8" W x 3-1/4" D, Exposed Screw Mounting	4.45
Metal Soap Holder, 3-7/8" W x 3-1/4" D, Exposed Screw Mounting	5.35
Metal Towel Ring with Clear Acrylic Ring, 5-7/8" W x 1-7/8" D, Exposed Screw Mounting	5.45

**COMMERCIAL SERIES - ACCESSORY LINE - WASHROOM**

---- Case ----				
Description	Detail	Qty	Lbs/Case	Price/each
Horizontal Wall-Mount Liquid Soap Dispenser	#304 Satin Stainless Overall: 8-1/4" W x 4-3/4" H x 3-3/4" D Capacity: 40 Ounces	24	17	53.00
Vertical Wall-Mount Liquid Soap Dispenser	#304 Satin Stainless Overall: 4-3/4" W x 8-1/4" H x 3-3/4" D Capacity: 40 Ounces	24	17	53.00
Wall-Mount Utility Shelf	#304 Satin Stainless Overall: 16" W x 4" H x 6" D	10	20	72.00
Wall-Mount Utility Shelf	#304 Satin Stainless Overall: 18" W x 4" H x 6" D	12	33	80.00



---- Case ----				
Description	Detail	Qty	Lbs/Case	Price/each
Wall-Mount Dual Toilet Tissue Dispenser	Cast Aluminum / Paint Color-Silver No Waste - Rocking Action Plastic Spindles Overall : 13-1/8" W x 1-3/4" H x 4" D Capacity : 2 Standard Rolls Toilet Tissue	21	12	25.40
Wall-Mount Dual Toilet Tissue Dispenser with Utility Shelf	#304 Satin Stainless Steel / 2 Plastic Rollers Overall: 14-3/4" W x 4-1/8" H x 5-1/16" D Capacity: 2 Standard Rolls Toilet Tissue	12	36	92.20
Locking Surface-Mount Dual Roll Toilet Tissue Dispenser	#304 Satin Stainless Steel / 2 Plastic Rollers Auto Drop Down Overall : 6" W x 11" H x 5-3/4" D Capacity : 2 Standard Rolls Toilet Tissue	12	24	124.75

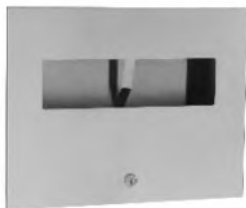

---- Case ----				
Description	Detail	Qty	Lbs/Case	Price/each
Wall-Mount Toilet Seat Cover Dispenser	#304 Satin Stainless Steel Overall: 15-5/8" W x 11-1/2" H x 1-7/8" D Capacity: 500 Single or Half Fold Seat Covers	12	15	50.95
Surface Mount Sanitary Napkin Disposal	#304 Satin Stainless Steel Overall: 8" W x 11" H x 4" D Capacity: 1 Gallon Receptacle	12	18	58.45
Locking Wall-Mount Paper Towel Dispenser	#304 Satin Stainless Steel Overall: 11-1/4" W x 14-1/2" H x 4-1/8" D Capacity: 400 C-Fold / 525 Multi-Fold Paper Towels	6	13	66.10

**COMMERCIAL SERIES - ACCESSORY LINE - HOSPITALITY**

CONSULT FACTORY FOR ADDITIONAL ITEMS NOT SHOWN



-- Case --

Description	Qty	Lbs / Ea.	Price
18" Heavy Duty Towel Shelf with Bar, 18" Mounting Centers - #304 Stainless Heliarc Welded / Polished SS	1	8	139.55
24" Heavy-Duty Towel Shelf with Bar, 24" Mounting Centers - #304 Stainless Heliarc Welded / Polished SS	1	10	153.45
24" Towel Shelf with Bar and Support Brackets, 24" Mounting Centers Chrome Plated Brackets, Polished SS Rods	10	3	83.60
30" Sturdy Towel Shelf, 29" Mounting Centers 30" W x 8" H x 12" D - # 304 Stainless / Satin SS	1	15	272.95
30" Sturdy Towel Shelf with Robe Hook Rack, 29" Mounting Centers 30" W x 8" H x 12" D - # 304 Stainless / Satin SS	1	15	323.20

**CUSTOM TOWEL SHELF DESIGNS & FINISHES AVAILABLE. CALL FOR A QUOTATION.**

-- Case --

Description	Qty	Lbs / Ea.	Price
Classic Surface Mount Single Paper Holder, Controlled Release 6" W x 2-3/4" H x 4-1/4" D / Chrome Plated	48	1	19.70
Classic Surface Mount Double Paper Holder, Controlled Release 12-1/4" W x 2-3/4" H x 4-1/4" D / Chrome Plated	24	2	35.80
Premiere Surface Mount Single Paper Holder - Concealed Hinge, Controlled Release 5-1/2" W x 2-3/4" H x 4-1/4" D / Chrome Plated	1	2	37.65
Premiere Surface Mount Double Paper Holder - Concealed Hinge, Controlled Release 10-1/2" W x 2-3/4" H x 4-1/4" D / Chrome Plated	1	4	49.90



-- Case --

Description	Qty	Lbs / Ea.	Price
Liquid Soap Dispenser - Wall Mount - Chrome with Plastic Globe 3-5/8" W x 6-3/4" H x 5-3/8" D	24	1	18.10
Retractable Clothesline with 10' Spring Loaded Nylon Cord, 3-5/8" Dia. x 3-1/4" D Chrome Plated Cover and Flange	60	1	43.40
Recessed Facial Tissue Box - No Cover Wall Opening 10-1/2" W x 5" H x 2-1/4" D	24	1	22.75
Recessed Facial Tissue Box with Stainless Cover Wall Opening 10-1/2" W x 5" H x 2-1/4" D	25	1	37.95

**COMMERCIAL SERIES - ACCESSORY LINE - HOSPITALITY**

PRICES DO NOT INCLUDE MOUNTING CLAMP  
MOUNTING CLAMP SOLD SEPARATELY



----- Case -----			
Description	Qty	Lbs / Ea.	Price
Extra Roll Recessed Paper Holder - Plastic, Spring Loaded White Roller Chrome Trim, Wall Opening 5-1/4" Sq. x 4" D	20	2	42.50
Double Recessed Paper Holder - Plastic, Spring Loaded Chrome Rollers Wall Opening 11-1/4" W x 5-1/4" H x 1-3/4" D	20	4	76.00
Double Surface Paper Holder - Plastic, Spring Loaded Chrome Rollers Chrome Plated Brackets, 13" W x 2-1/2" H x 3-1/8" D	24	2	43.30

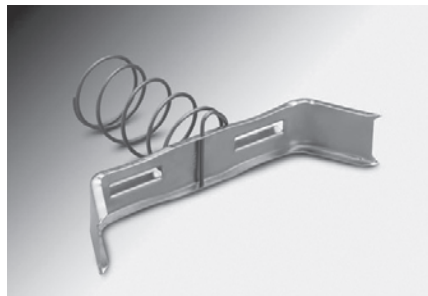

----- Case -----			
Description	Qty	Lbs / Ea.	Price
Soap or Tumbler Holder with Metal Lip, 6-1/4" Sq. x 2" D	40	1	35.80
Wall Opening 5-1/4" Sq. x 2" D - #304 Stainless / Polished SS			
Paper Holder - Plastic, Spring Loaded White Roller, 6-1/4" Sq. x 2" D	40	1	35.80
Wall Opening 5-1/4" Sq. x 2" D - #304 Stainless / Polished SS			

**MOUNTING CLAMP**

----- Case -----			
Description	Qty	Lbs / Ea.	Price
Mounting Clamp with Retention Spring, 7" W x 1-1/2" H x 4-5/8" D	---	1	6.75

**TERMS AND CONDITIONS****PAYMENT**

NET 30 DAYS. All accounts, payable in U.S. funds, are due within 30 days after delivery of goods to Buyer or any common or contract carrier, whichever occurs first. Payments by check, draft, or any mode other than cash is conditional and for Buyer's convenience and is not deemed payment until cash or solvent credit is received and accepted by H&H.

**FREIGHT TERMS**

All orders F.O.B. Long Beach, CA.

Shipments consigned outside the continental U.S. will be shipped to the nearest U.S. port. Prepaid freight terms may vary on a product-by-product basis. Please call the factory for freight terms on your particular order.

**MINIMUM ORDER**

Minimum order requirement is \$50.00. Any order received for merchandise with a net amount less than \$50.00 will be invoiced at \$50.00, plus any applicable freight charges.

**ORDER REQUIREMENTS**

All telephone orders must be confirmed in writing. H&H will not assume errors in telephone orders unless written or faxed confirmation is received.

**RETURNS**

Returns will only be accepted with written authorization. A 30% restocking charge shall be assessed on all returns. A Return Merchandise Authorization (RMA) number must accompany all returned goods. All returned goods are to be shipped to H&H prepaid.

**CLAIMS**

Claims for shortage, loss, or damage in transit must be submitted within 48 hours of delivery.

**LIMITED WARRANTY**

All H&H products will be replaced within one year of shipment if defective in workmanship or material. H&H will not be liable for any labor, damage or other expense of any kind incurred in connection with the sale or use of H&H products. There is no warranty as to the durability of finishes.

**PRODUCT CARE**

The durability of finishes can be preserved by cleaning only with a wet soft cloth or ammonia cleaner. No chlorine cleaners or abrasives. No guarantee is given as to custom finish items.

**ADJUSTMENTS AND BUYER REMEDIES**

All claims for defective workmanship or material must be made within 30 days after claim arises and must be in writing. H&H excludes any warranty of fitness for a particular purpose. Buyer's exclusive remedy for the furnishing of materials not conforming to any contract shall be at H&H's option to secure the replacement thereof or payment of the claim, which shall not exceed the price of the sale in respect of which such claim is made. In no event shall H&H be liable for any special, indirect, incidental or consequential damages.

**DELAYS**

Every order is accepted subject to, and Seller is excused for a delay in performance caused by accidents, strikes, riots, labor stoppage, car shortage, climate conditions, unavoidable casualties, or other causes interfering, obstructing or blocking the usual routes of transportation, whether similar or dissimilar to those mentioned above, and no claim for loss or damages shall be allowed Buyer in consequence thereof. Seller may rescind any order without liability after acceptance for any of said causes.

**CANCELLATIONS**

Orders shall not be cancelled except upon mutual agreement. Orders for custom merchandise cannot be cancelled.

**RIGHT TO REFUSE TO MAKE SHIPMENT**

Seller may, at any time, decline to make any shipment or delivery or perform any work except upon receipt of full cash payment.

**CREDIT POLICY**

Initial orders for new accounts are cash or credit card with order. Accounts not paid by the due date will be charged an administrative late charge at the rate of one and one-half percent (1-1/2%) per month, applied against the previous balance after deducting payments and credits received prior to the due date. Buyer acknowledges that H&H will incur losses not easily ascertainable in advance in the event of late payment by Buyer, and Buyer agrees to pay such late fee in order to compensate H&H for such damages as it may sustain. If it is necessary to employ an attorney or incur any other cost to collect this account, Buyer shall pay all fees and costs in addition to any amounts due hereunder. Should any portion of Buyer's account become past due, H&H shall have the right to declare all invoices due and payable.



**626-344-9779 / 833-448-6329**

**[www.HHBathandSafety.com](http://www.HHBathandSafety.com)**

**100% A.D.A Compliant**

**Made in the USA**